

NOTICE OF HEARING

NOTICE IS HEREBY GIVEN that the City Council of the City of Daly City intends to adjust, as authorized, a benefit assessment imposed for Fiscal Year 2025-2026 on certain real property for the purpose of continuing maintenance and operation of certain services benefiting certain real property, pursuant to the Benefit Assessment Act of 1982, and Resolution No. 90-55, adopted on February 12, 1990.

The real property upon which the assessment is proposed to be levied is described in Exhibit “A” hereto (being all parcels to be assessed within the “Area of Benefit”). The revenue derived from the continued assessment will be used to finance the maintenance and operation of services as outlined in the *Linda Vista Engineer’s Report 2025-2026 Fiscal Year*, on file in the Office of the Daly City City Clerk.

The City Council has, by its originating Resolution No. 90-55, determined that a benefit assessment shall be initially adjusted pursuant to the Act on the real property within the Area of Benefit for the purpose of providing the specified maintenance and operation services. In accordance with Resolution No. 90-55, the City Manager has caused a written report (the “Engineer’s Report”) to be prepared and filed with the City Clerk, which report contains the following information: (1) a description of the Services; (2) a description of each parcel of real property located within the Area of Benefit; (3) the estimate of the cost of providing the services during Fiscal Year 2025-2026, the aggregate amount to be assessed to Area of Benefit for such year, and the amount of the proposed assessment for each parcel within the Area of Benefit for such year, and (4) the basis and schedule of the assessment.

The Engineer’s Report is on file with the City Clerk and is available for inspection on the City’s website www.dalycity.org.

NOTICE IS FURTHER GIVEN that Monday, the 12th day of May 2025, at the hour of 7:00 P.M., in the City Council Chambers, City Hall, 333 90th Street, Daly City, California, is hereby fixed as the time and place when the City Council of the City of Daly City will hear and consider all comments related to the Engineer’s Report and to the adjustment of benefit assessments for Fiscal Year 2025-2026 for the purpose of providing the Services. The meeting can be attended in person at the above address or watch the live telecast at <https://www.youtube.com/@DalyCityGov/stream> or <https://www.dalycity.org/agendas>. Citizens are encouraged to provide comments by attending in person and/or submit public comments via email to cityclerk@dalycity.org prior to 4pm on the day of the public meeting

The amounts proposed to be assessed for Fiscal Year 2025-2026 are set forth in Exhibit “A” and are generally summarized as follows:

LINDA VISTA I BASIN AREA \$151.13 per lot (Generally, lots along Linda Vista Drive, Jacqueline Court, Jacqueline Lane, a portion of Schwerin Street and a portion of Bay Ridge Drive)	BAY RIDGE BASIN AREA \$100.46 per lot (Generally, lots along Alexis Circle, Bay Ridge Drive, Sharon Court and Nancy Lane)
--	--

For further particulars, interested persons are referred to the Engineer’s Report, the Act, and Resolution No. 90-55. Inquiries regarding the hearing on the Engineer’s Report should be directed to the Office of the City Engineer of the City of Daly City, which office can be contacted during regular office hours at the Daly City Civic Center, 333 90th Street, Daly City, California, 94015, or by calling (650) 991-8064.

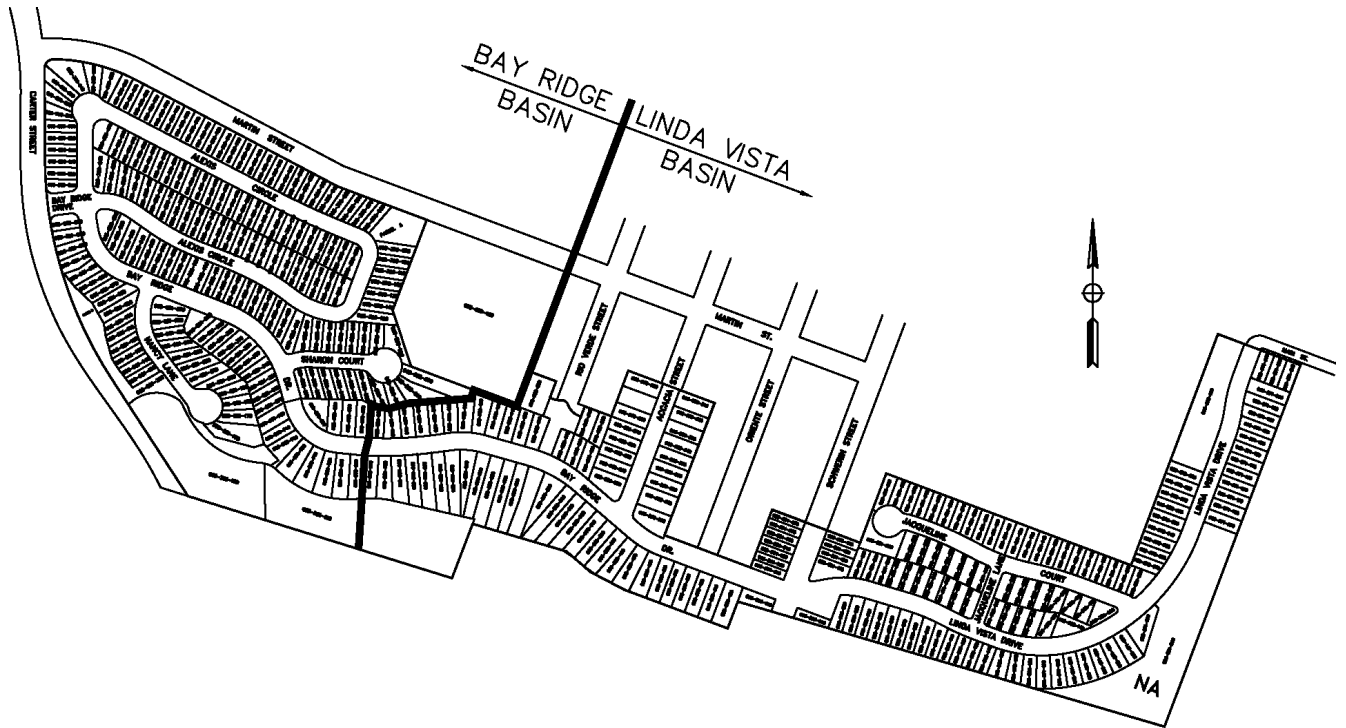

DIAGRAM OF LINDA VISTA AREA OF BENEFIT

(BENEFIT ASSESSMENT ACT OF 1982)
CITY OF DALY CITY, SAN MATEO COUNTY, CA.

NA = NO ASSEMENT FOR
THE NOTED LOTS

Dated: March 24, 2025

K. Annette Hipona
City Clerk, City of Daly City

LINDA VISTA AREA OF BENEFIT**ASSESSMENT ROLL
FISCAL YEAR 2025-2026****LINDA VISTA:**

Certain Parcels along Linda Vista Drive, Jacqueline Court, Jacqueline Lane, a portion of Bay Ridge Drive and Schwerin Street identified with the following Assessor's Parcel Numbers @ \$151.13 each parcel:

Parcels:	005-361-010 thru 440	(44 total)
	005-362-010 thru 140	(14 total)
	005-363-020 thru 170	(16 total)
	005-364-010 thru 070	(7 total)
	005-371-010 thru 230	(23 total)
	005-372-010 thru 090	(9 total)

BAY VISTA:

Parcels:	005-530-050 thru 670	(63 total)
		176 Total

BAY RIDGE:

Certain Parcels along Alexis Circle, Bay Ridge Drive, Nancy Lane and Sharon Court identified with the following Assessor's Parcel Numbers @ \$100.46 each parcel:

Parcels	005-390-010 thru 930	(91 total)
	005-521-010 thru 370	(37 total)
	005-522-010 thru 370	(37 total)

BAY VISTA:

Parcels:	005-530-010 thru 040	(4 total)
	005-530-680 thru 750	(8 total)
		177 Total